

# Instructions

Punta: S-PU-XX/40/\_



## Safety Precautions.

- Power Isolation: Always disconnect the power supply before installing, removing, or servicing the product to prevent electric shock, injury, or damage.
- Qualified Installation: Luminaires should be installed by a certified electrician in accordance with current local wiring regulations.
- Damaged Components: Replace any broken or faulty parts promptly. Spectre Lighting cannot be held liable for issues resulting from poor installation practices.
- Ambient Temperature: Ensure the room temperature does not exceed 40°C during operation.
- Power Supply Compatibility: These products are intended for use with a mains supply of 220–240V~ at 50/60Hz.
- Inrush Current Consideration: You may need to upgrade your MCBs to accommodate higher inrush currents.
- Insulation Testing: Do not perform insulation resistance tests while the product is connected to the circuit.
- Preparation: Review all instructions thoroughly and confirm you have the necessary tools and accessories for proper installation.

5yrs  
Warranty

Spectre Lighting  
Unit 8 Gemini 8 Business Park  
Charon Way  
Apollo Park  
Warrington  
WA5 7AE  
www.spectre-lighting.com

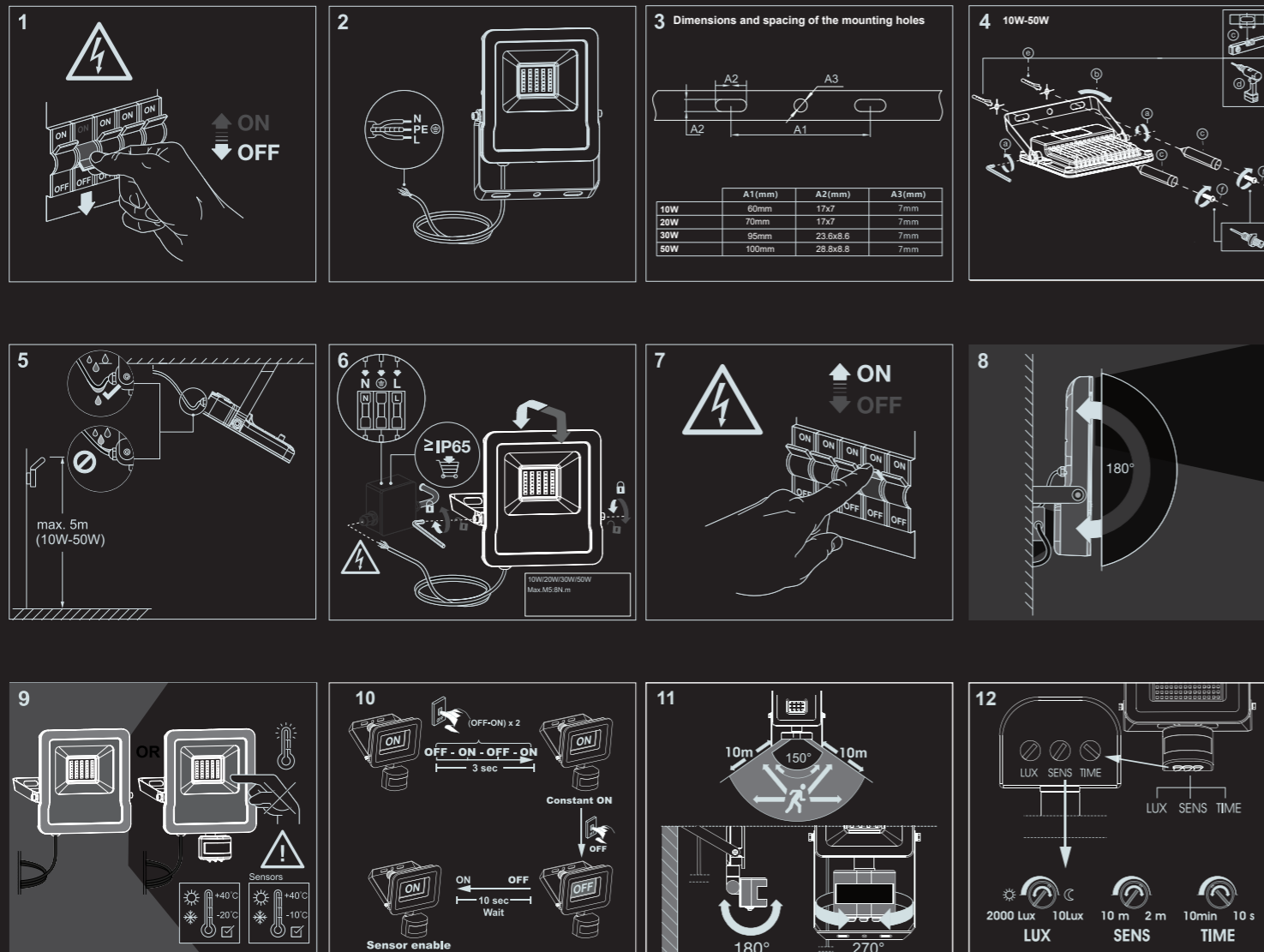

## Installation Instructions

Fig 1. Ensure power supply is isolated before proceeding with installation.

Fig 2. Product is supplied with supply cable as standard. Check and ensure correct polarity is observed.

Fig 3. Select desired mounted surface / location. Fixing and mounted details listed for reference.

Fig 4. Mounting brackets designed to allow installation without removal. Angle bracket and mount to desired surface using fixings supplied.

Fig 5. Allow cable to have a slight downward loop (drip loop) to prevent water gathering at cable entry point. Failure to do so could result in water ingress and void any warranty.

Fig 6. Feed supply cable into external mounting box with an IP rating of IP65 or above. Connect supply cables to main terminals. These products are intended for use with a mains supply of 220–240V~ at 50/60Hz.

Fig 7. Adjust the floodlight angle directing the output to the intended illuminated area.

Fig 8. Reinststate power supply.

## PIR Option Instructions

Fig 9. Please note temperature range for PIR operation.

Fig 10. Manual override option. Turn power on / off twice within 3 seconds for constant operation. To revert back to PIR operation, turn power off for 10 seconds.

Fig 11. PIR detection area 10m from PIR sensor. The PIR is independently adjustable. Adjust to area to trigger Floodlight operation.

Fig 12. The PIR has 3 adjustments on the underside.  
LUS – Daylight sensor operation.  
SENS – Area of coverage.  
TIME – Time delay before turning off.

IP65 / IP54 PIR



# Instructions

## Punta: S-PU-XX/40/\_



### Specification

- Voltage Range – 220-240V 50/60Hz
- CCT – 4000K
- IP65(PIR - IP54) IK06
- CRI80
- 100Lm/W
- Temp Range -20 – 40°C(PIR -10 – 40°C)

#### S-PU-10/40/B

- 10W
- 1000lm

#### S-PU-30/40/B

- 30W
- 3,000lm

#### S-PU-20/40/B

- 20W
- 2,000lm

#### S-PU-50/40/B

- 50W
- 5,000lm

#### S-PU-10/40/PIR/B

- 10W
- 1000lm

#### S-PU-30/40/PIR/B

- 30W
- 3,000lm

#### S-PU-20/40/PIR/B

- 20W
- 2,000lm

#### S-PU-50/40/PIR/B

- 50W
- 5,000lm

Spectre Lighting  
 Unit 8 Gemini 8 Business Park  
 Charon Way  
 Apollo Park  
 Warrington  
 WA5 7AE  
[www.spectre-lighting.com](http://www.spectre-lighting.com)

### Dimensions

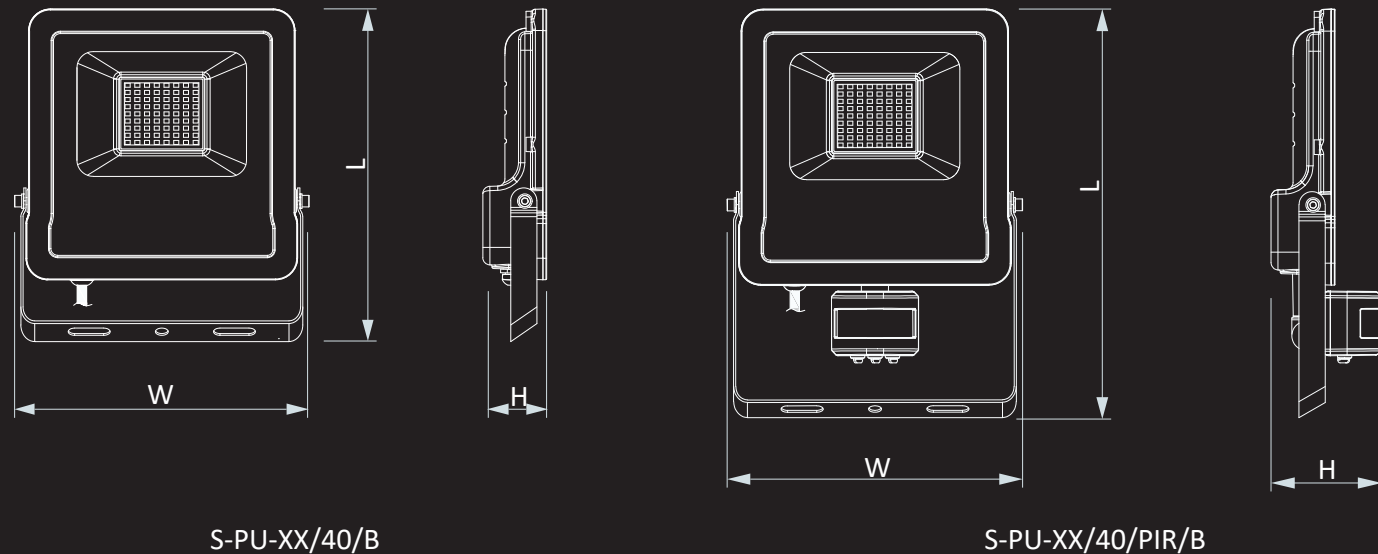

S-PU-XX/40/B

S-PU-XX/40/PIR/B

	W/mm	H/mm	L/mm	Windage/m <sup>2</sup>
S-PU-10/40/B	104	30	128	0.0087
S-PU-20/40/B	125	30	152	0.0128
S-PU-30/40/B	168	32	208	0.0249
S-PU-50/40/B	203	44	232	0.0353
S-PU-10/40/PIR/B	104	62	165	0.0113
S-PU-20/40/PIR/B	125	64	189	0.0130
S-PU-30/40/PIR/B	168	65	250	0.0275
S-PU-50/40/PIR/B	203	76	280	0.0379

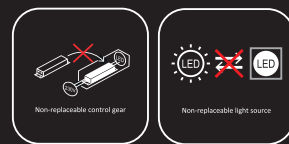

The light source of this luminaire is not replaceable; when the light source reaches its end of life the luminaire shall be replaced, utilising the existing driver.

### ⚠ Important Disposal Information for Waste Electrical & Electronic Equipment (WEEE)

Please be aware that Waste Electrical and Electronic Equipment (WEEE), identified by the crossed-out wheelee bin symbol, must NOT be disposed of with regular household waste.

We encourage you to support reuse, recycling, and responsible recovery by returning this product—once it reaches the end of its life—to an appropriate collection point. This may include a designated waste equipment centre, a civic amenity site, or the retailer where you originally purchased the item or are buying a replacement.

Improper disposal of this equipment may release substances that are harmful to both human health and the environment. To prevent this, it is essential that WEEE is separated from general waste and processed through approved recycling channels.

The crossed-out wheelee bin symbol serves as a reminder that this product requires special handling in accordance with local WEEE regulations.

## IP65 / IP54 PIR

