

# Installation Instructions

## RadiForm: S-RF-\_/CTS/W



Unit 8 Gemini 8 Business Park  
Charon Way  
Apollo Park  
Warrington  
WA5 7AE

www.spectre-lighting.com

### Safety Precautions.

- Power Isolation: Always disconnect the power supply before installing, removing, or servicing the product to prevent electric shock, injury, or damage.
- Qualified Installation: Luminaires should be installed by a certified electrician in accordance with current local wiring regulations.
- Damaged Components: Replace any broken or faulty parts promptly. Spectre Lighting cannot be held liable for issues resulting from poor installation practices.
- Ambient Temperature: Ensure the room temperature does not exceed 25°C during operation.
- Power Supply Compatibility: These products are intended for use with a mains supply of 230–240V~ at 50/60Hz.
- Inrush Current Consideration: You may need to upgrade your MCBs to accommodate higher inrush currents.
- Insulation Testing: Do not perform insulation resistance tests while the product is connected to the circuit.
- Preparation: Review all instructions thoroughly and confirm you have the necessary tools and accessories for proper installation.

5yrs  
Warranty

### Surface mounted

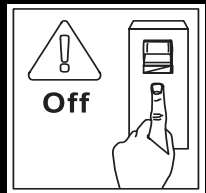

1

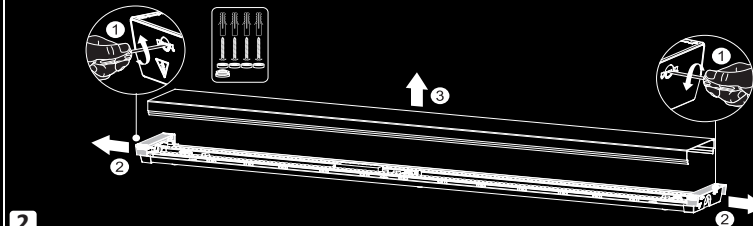

2

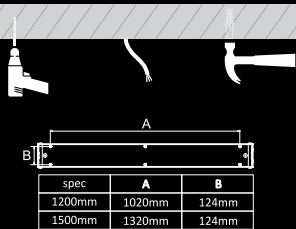

3

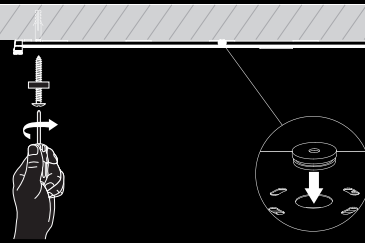

4

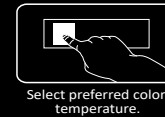

Select preferred color temperature.

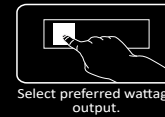

Select preferred wattage output.

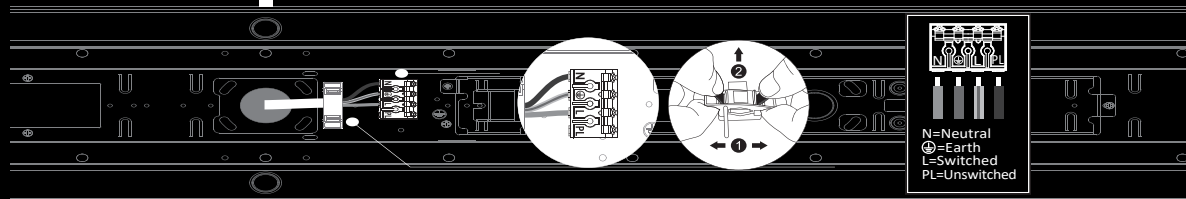

5

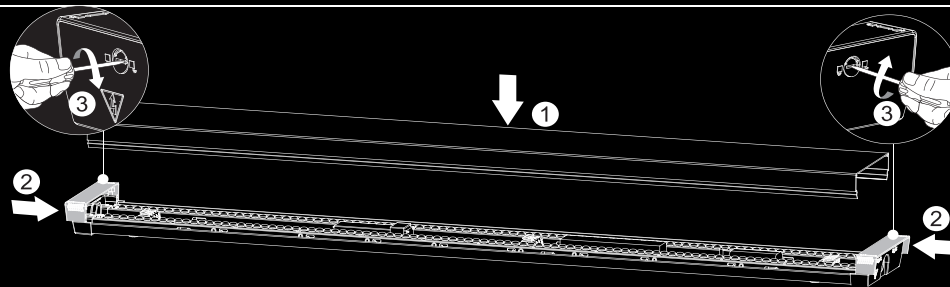

6

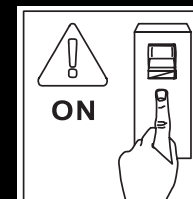

7

### Installation Instructions

Fig 1. Ensure power supply is isolated before proceeding with installation.

Fig 2. Unlock the end cap with screwdriver and move the end cap to the direction indicated by the arrow.

Fig 3. Locate desired surface for installation. Mark appropriate fixing hole positions on wall / ceiling, check location of buried cables, pipes, and other building services before drilling.

Fig 4. Set product to desired CCT using dip switches located on the PCB and set desired wattage output using the dip switches located on the driver.

Fig 5. Feed through supply cable into base via cable grommet. Connect the wire according to the instruction.

Fig 6. Put the diffuser back and lock the end cap with screwdriver.

Fig 7. Reinstate power supply.

IP44



## Emergency kit installation



Unit 8 Gemini 8 Business Park  
Charon Way  
Apollo Park  
Warrington  
WA5 7AE

[www.spectre-lighting.com](http://www.spectre-lighting.com)

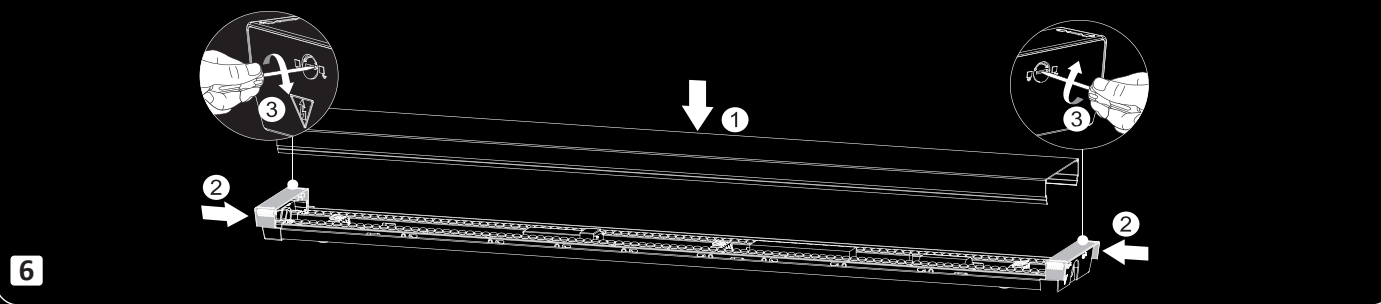
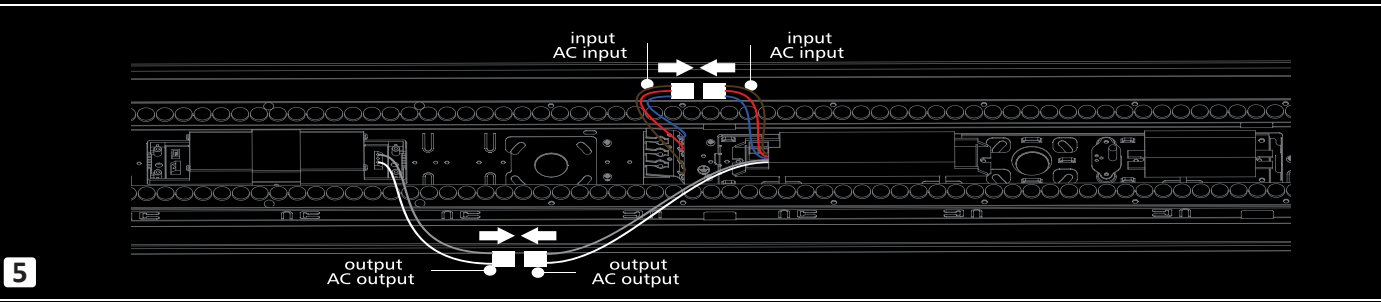
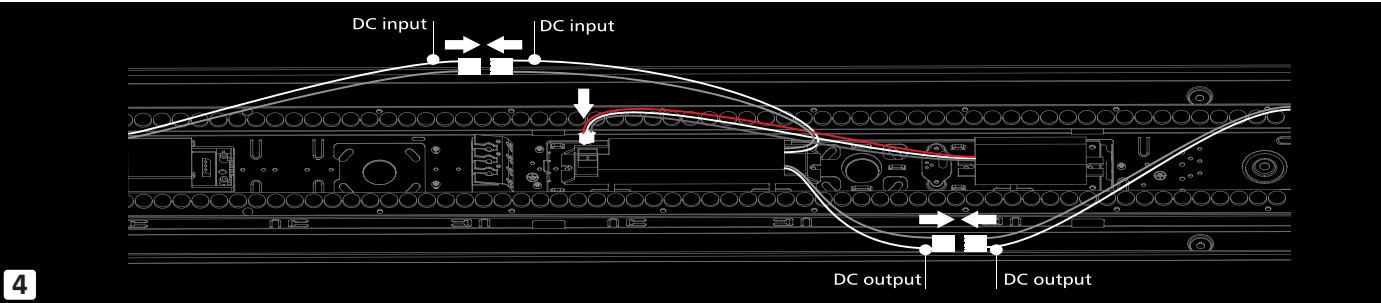
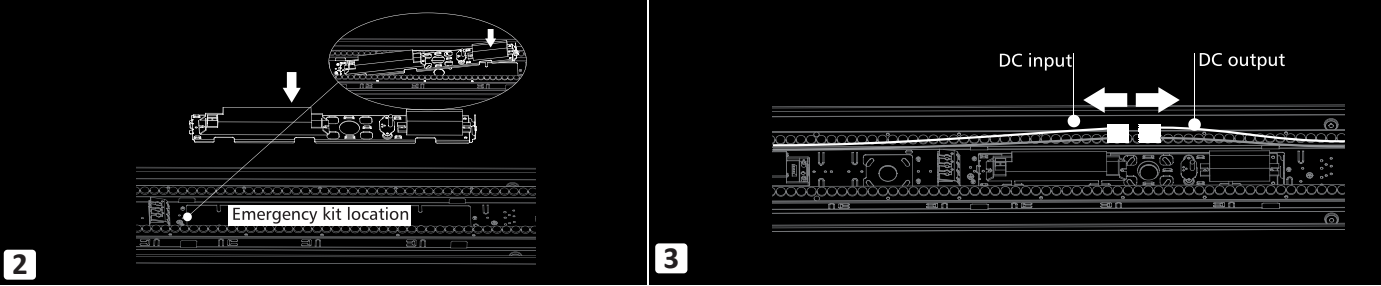
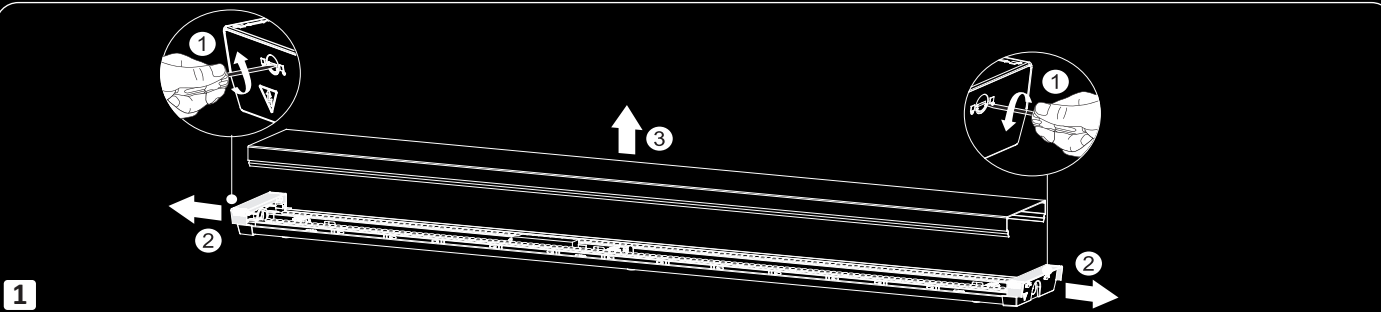

### Installation Instructions

Fig 1. Unlock the end cap with screwdriver and move the end cap to the direction indicated by the arrow.

Fig 2. Fix the emergency pack to the specified location

Fig 3. Disconnect the DC connector

Fig 4. Connect the DC input connector and DC output connector

Fig 5. Connect the AC input connector and AC output connector

Fig 6. Put the diffuser back and lock the end cap with screwdriver.

IP44



## Sensor installation(on/off microwave sensor)



Unit 8 Gemini 8 Business Park  
Charon Way  
Apollo Park  
Warrington  
WA5 7AE

[www.spectre-lighting.com](http://www.spectre-lighting.com)

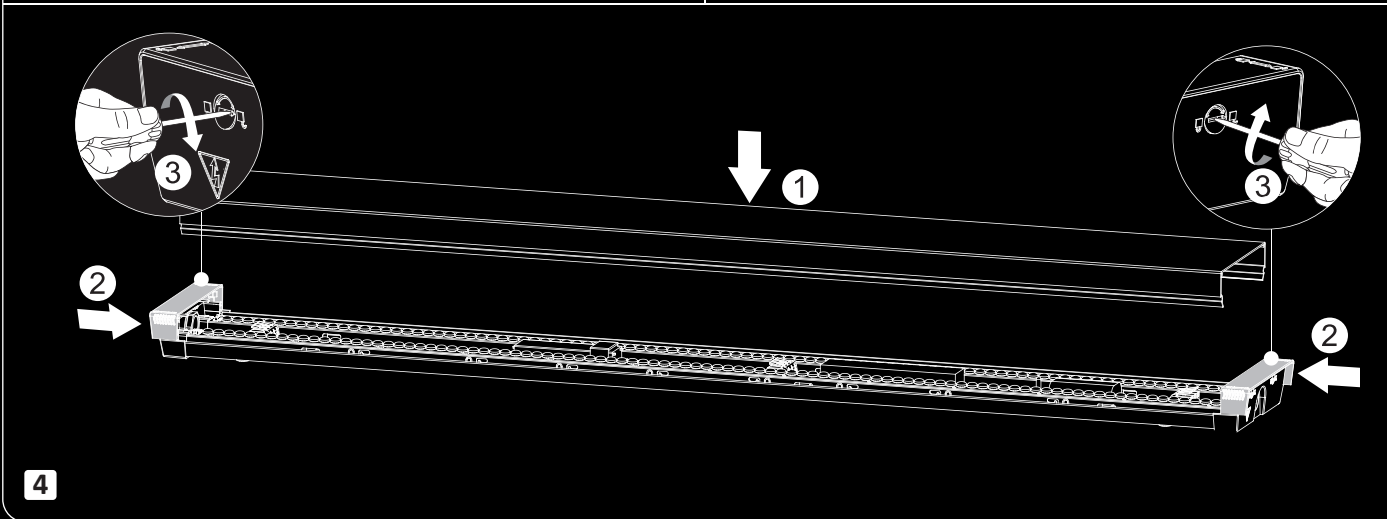
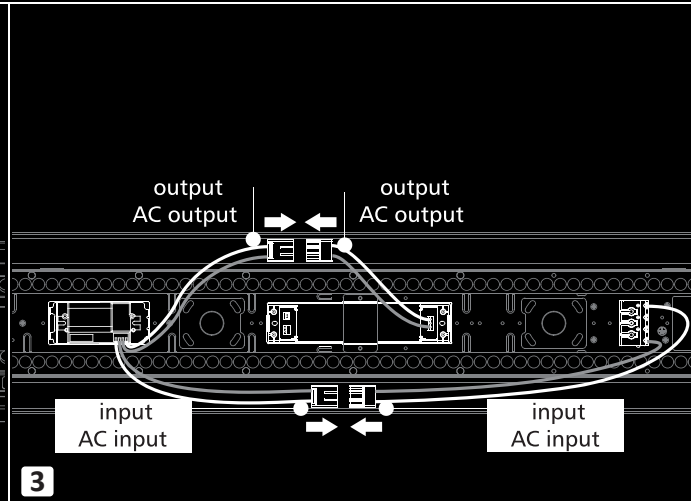
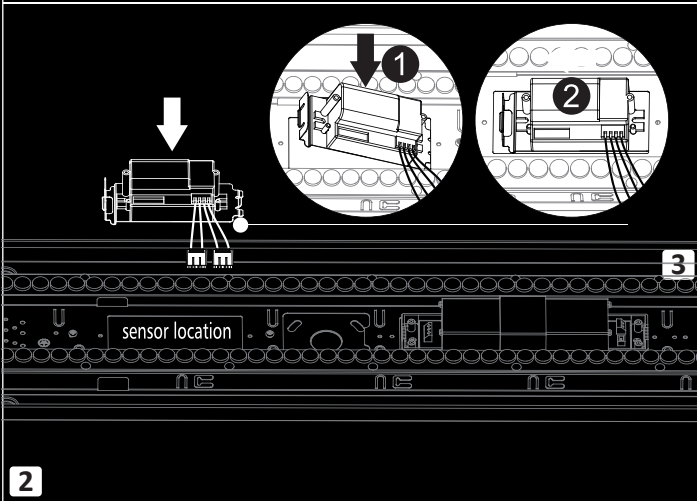
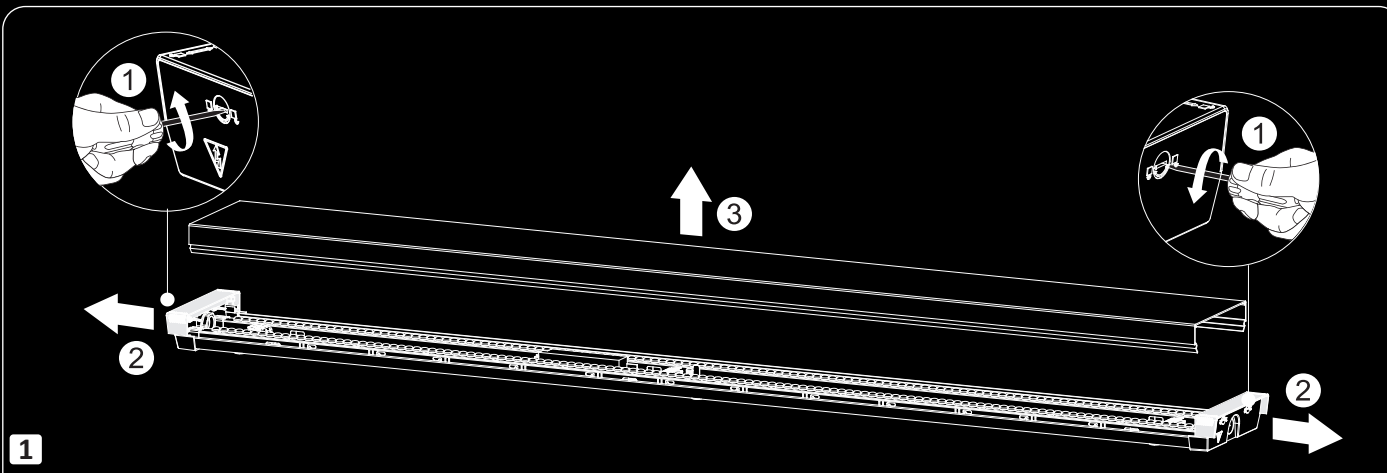

### Installation Instructions

Fig 1.Unlock the end cap with screwdriver and move the end cap to the direction indicated by the arrow.

Fig 2.Fix the sensor to the specified location

Fig 3.Connect the AC input connector and AC output connector

Fig 4.Put the diffuser back and lock the end cap with screwdriver.

IP44



## Functions Instruction (For specific function, please refer to actual model)



### Emergency

Emergency function switches automatically between power cut and power restoration.

- Li battery, high efficiency
- Battery duration: 3 hours
- Charge period: 24 hours



### Sensor

Detection area: 140 degree wide detectable beam angle with 4-6 meters distance.

## Driver Datasheet (Emergency)

Input power	3W
Discharge power	2W
Rated Input Voltage(V)	AC230V
Frequency	50/60Hz
Input Voltage	AC220-240V
Rated Input Current	≤0.05A
Output Voltage range(V)	DC54-150V
Battery	6.4V 1500mAh(LiFePO4)
Lifetime	Over 2000 cycles
Battery duration	≥3hrs
Charge Period	≤24hrs
Emergency switching time	≤1S
Emergency Operating Temp. (°C)	0°C-25°C

## Instructions for automatic test option

- Once the unit is powered up, it will automatically initiate a self test and diagnostics as follows:
    - Every 4 seconds: Checks for battery disconnection, charger board fault, lamp failure and transformer failure.
    - Every month: Performing a 3 minutes duration test.
    - Every year: Performing a 3 Hours duration test.
- All test functions are factory preset and do not need field adjustment.

## 2. Dual Colour Indicator LED Status Mesnings.

Green	Solid On	Ready/Normal Operation
	Flashing	Testing
Red	Requires Service	
On	Red indicator on	Battery temperature abnormal
On+flash	Red indicator on and flash	Battery not be connected
flash	Flash twice within 4 seconds	Low battery voltage
flash	Flash 3 times within 4 seconds	Charger board fault
flash	Flash 4 times within 4 second	Transformer fault

### Note:

- 1) This product should be installed by a registered electrician in accordance with local standards and electrical regulations.
- 2) Ensure the power supply is under isolated before installation.
- 3) Sealed LiFePO4 rechargeable battery pack, the battery should be replaced when the required duration is no longer achieved.
- 4) To avoid any damage to the fixture and ensure its performance, the battery should be replaced with same brand and type.

## Datasheet Sensor (on/off microwave sensor)

Sensor datasheet	
Operating Voltage	AC220-240V 50/60Hz
Power consumption	1.5W±0.5W
Microwave frequency	5.8GHz±75MHz, ISM wave band
Transmission power	<0.5mW
Detection angle	140°
Detection Area	4-6M 100%/75%/50%/25% are adjustable by DIP switch
Hold time	5S/30S/1min/3min/5min/10min/20min/30min are adjustable by DIP switch
Daylight sensor	2Lux/10Lux/25Lux/50Lux/Disable are adjustable by DIP switch
Stand-by DIM Level	-
Stand-by Period	-
Dimming Range	-
Microwave ON/OFF function	-
Installation Height	Recommended Installation Height: Ceiling mounted height 3m.
Minimum mounting distance	Recommended mounting distance should be more than 3m
Operating temperature(°C)	-20°C~60°C

## Sensor Setting

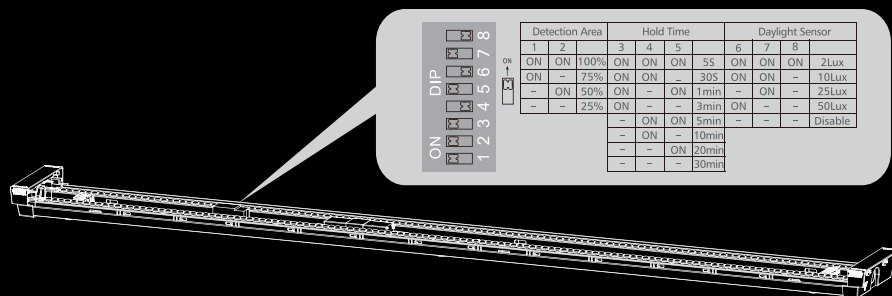

## Factory setting

Detection Area	Hold time	Daylight sensor
100%	1min	25Lux

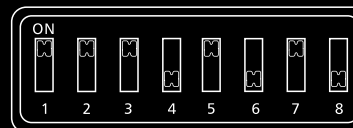

Detection Area			
	1	2	
I	ON	ON	100%
II	ON	-	75%
III	-	ON	50%
IV	-	-	25%

### Detection area:

**Sensor test condition:** The test is based on 3m height, the detect distance radius is based on ground, the detect distance can be adjusted through the slide switch.

**Sensor test environment and reference:** The detective range is measured by human body whose stature is around 1.6-1.7M with medium size and traveling speed is around 1.0-1.5M per second. If the stature, bodily form and traveling speed are changed, then the detective range will be changed accordingly.

**Sensor lamp's reaction under open/narrow environment:** Test result will be highly influenced by test environment, the more open environment, the closer detect distance; the narrower environment, the longer detect distance. The detector may do self-excitation in a narrow environment.

**Sensor Setting based on environmental disturbance:** Some environmental disturbances will cause abnormal induction, such as the lamp can not automatically turn off for a long time or the sensor function is invalid, then users can adjust sensor distance to reach the ideal effect. It is recommended to adjust the sensing distance to 50% for the environment where near the heavy equipment, metal sheets and metal pipes, concrete wall (<30cm thickness) etc. Recommend to keep 100% sensor distance in open environment. For environment where near the routers, telecommunications base stations, electrical machinery etc, it is recommended to keep the installation distance of more than 5 meters and adjust to 50% sensor distance.

Hold Time				
	3	4	5	
I	ON	ON	ON	5S
II	ON	ON	-	30S
III	ON	-	ON	1min
IV	ON	-	-	3min
V	-	ON	ON	5min
VI	-	ON	-	10min
VII	-	-	ON	20min
VIII	-	-	-	30min

### Hold time:

Refers to the time period the lamp remains at 100% illumination after no motion detected.

**Notice 1:** The hold time can be selected by the slide switch.

The hold time counting should be started after the sensor is powered on and initialized.

Daylight Sensor				
	6	7	8	
I	ON	ON	ON	2Lux
II	ON	ON	-	10Lux
III	-	ON	-	25Lux
IV	ON	-	-	50Lux
V	-	-	-	Disable

### Daylight sensor:

The sensor can be set to only allow the lamp to illuminate below a defined ambient brightness threshold. When set to Disable mode, the daylight sensor will switch on the lamp when motion is detected regardless of ambient light level.

**Notice 1:** The light threshold can be selected through the slide switch, it may cause a large deviation in different lamps.

## Induction Range

### Ceiling Mounting pattern(Unit: m)

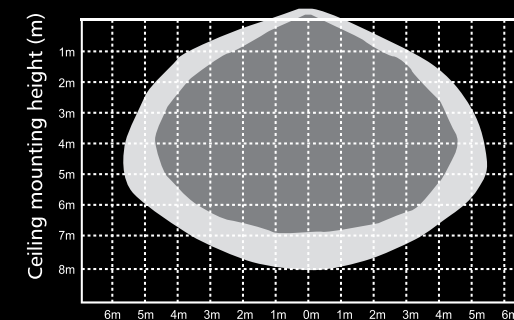

■ High detection area ■ Low detection area

# Installation Instructions

## RadiForm: S-RF-\_/ CTS/W



Unit 8 Gemini 8 Business Park  
Charon Way  
Apollo Park  
Warrington  
WA5 7AE

[www.spectre-lighting.com](http://www.spectre-lighting.com)

### Specification

#### S-RF-4/CTS/W

- Voltage Range – AC 220-240V 50/60Hz
- CCT – 3000K / 4000K / 6500K
- CRI80
- IP44/IK06
- 24W / 29W / 33W / 38W
- 4,100Lm – 4,400Lm / 120Lm/W
- Temp Range –20°C –45 °C

### Specification

#### S-RF-5/CTS/W

- Voltage Range – AC 220-240V 50/60Hz
- CCT – 3000K / 4000K / 6500K
- CRI80
- IP44/IK06
- 24W / 29W / 33W / 38W
- 4,100Lm – 4,400Lm / 120Lm/W
- Temp Range –20°C –45 °C

### Dimensions

S-RF-4/CTS/W	S-RF-5/CTS/W
L1200*W165*H50mm	L1500*W165*H50mm

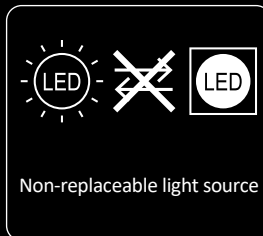

The light source of this luminaire is not replaceable, when the light source reaches its end of life the luminaire shall be replaced, utilising the existing driver



### Important Disposal Information for Waste Electrical & Electronic Equipment (WEEE)

Please be aware that Waste Electrical and Electronic Equipment (WEEE), identified by the crossed-out wheellie bin symbol, must NOT be disposed of with regular household waste.

We encourage you to support reuse, recycling, and responsible recovery by returning this product—once it reaches the end of its life—to an appropriate collection point. This may include a designated waste equipment centre, a civic amenity site, or the retailer where you originally purchased the item or are buying a replacement.

Improper disposal of this equipment may release substances that are harmful to both human health and the environment. To prevent this, it is essential that WEEE is separated from general waste and processed through approved recycling channels.

The crossed-out wheellie bin symbol serves as a reminder that this product requires special handling in accordance with local WEEE regulations.

**IP44**

